

諾華系列 辦公家具鎖

3001-22-01 Drawer Lock

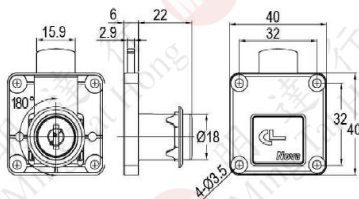

- ▶ Click action mechanism
- ▶ Key removable in locked & unlocked positions
- ▶ Master key system
- ▶ Zinc alloy die cast



貨號	包裝(把)
3001-22	20

3604-22-01 Push Lock



- ▶ Push-in locking, no key required when locking
- ▶ Click action mechanism
- ▶ Key removable in locked & unlocked positions
- ▶ Master key system
- ▶ Zinc alloy die cast
- ▶ Accessories options: Extension pin (DU036)

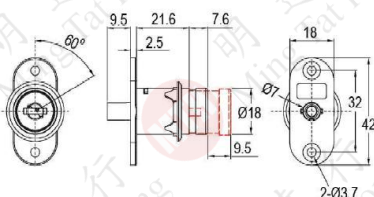

貨號	包裝(把)
3604-22	20

3607-20-01-C10 Cam Lock



- ▶ 90° and 180° rotary cam movement, convertible
- ▶ Click action mechanism
- ▶ Key removable in locked & unlocked positions
- ▶ Master key system
- ▶ Zinc alloy die cast

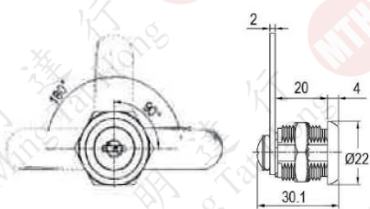

貨號	包裝(把)
3607-20	20

3607-25-01-C18 Cam Lock



- ▶ 90° and 180° rotary cam movement, convertible
- ▶ Click action mechanism
- ▶ Key removable in locked & unlocked positions
- ▶ Master key system
- ▶ Zinc alloy die cast

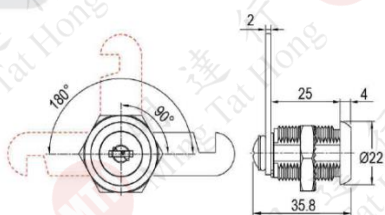

貨號	包裝(把)
3607-25	20

3607-30-01-C18 Cam Lock



- ▶ 90° and 180° rotary cam movement, convertible
- ▶ Click action mechanism
- ▶ Key removable in locked & unlocked positions
- ▶ Master key system
- ▶ Zinc alloy die cast

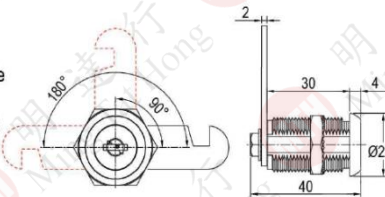

貨號	包裝(把)
3607-30	20